

| Cable seal details | |
|--------------------|---------|
| ref. | dim. XX |
| S682028 | 1.60 |
| S682835 | 2.40 |
| S681620 | 1.25 |

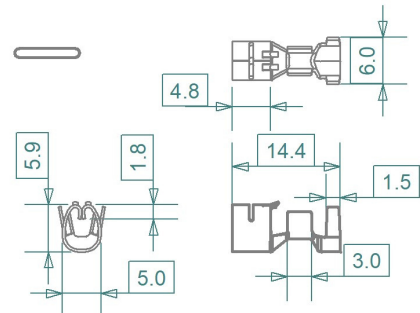
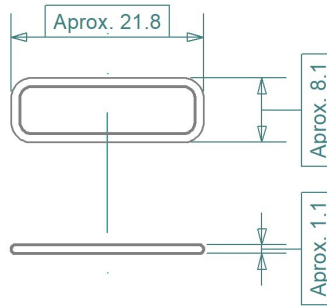

| ref. | Description | Material | Note |
|-----------------|--------------------------------|---------------|----------------------|
| H1151 | single holder | PA 6 | black |
| H1152 | clear cover | PC | transparent |
| H1153 | O - ring | PVC | black |
| H1154L - H1154R | mounting bracket | PA 6 | black |
| CCS150FR | contact 1.0-2.5mm ² | CuZn33 | Sn plated, reeled |
| S681620 | cable seal, violet | LSR, 50 shore | HD 6.8mm, ø1.6-2.0mm |
| S682028 | cable seal, green | LSR, 50 shore | HD 6.8mm, ø2.0-2.8mm |
| S682835 | cable seal, gray | LSR, 50 shore | HD 6.8mm, ø2.8-3.5mm |

Notes: fuse holder suited for MIDI normOTO blade fuse series F1000, F1500 and F1900(LED) up to 30A.
Contact suitable for wire diameters 1.0 - 2.5mm²

| Revisions | | | Drawn | Date | Appr. | | |
|-----------|-------|-------------------------------------|--------------|---------------------------------|-------|----------------|---|
| a | 12/08 | re-drawn | Checked | 10/00 | AdH | | |
| b | 09/09 | scaling, dimensions corrected | Standards | 09/20 | BE | | |
| c | 08/11 | updated contact & seal part numbers | Approved | 09/20 | GRH | | |
| d | 03/12 | updated contact dimensions | | | | | |
| e | 05/12 | updated contact dimensions | Not to scale | | | Title | H1150 series, normOTO blade fuse holder |
| f | 06/20 | updated contact materials | Projection | Tolerance | | Drawing type | schematic |
| g | 09/20 | corrected O-ring material | | ± 0.2 mm unless otherwise noted | | Drawing number | H1150 drawing 1 |
| | | | | | | Sheet | 1 of 1 |
| | | | | | | Layers / Sheet | 0 1 2 4 6 7 8 9 11 Sheet 01 |